



# Retail Grade Rod Parts Breakdown

REV: A

DOM ON/BEFORE 07.29.24

The following parts are **DISCONTINUED**:  
 #9 (1000-1014)  
 #19 (1000-1008)

PLEASE ORDER SLIDE REPLACEMENT KIT  
**1000-1006-2** AND SEE VIDEO ON REPLACE  
 SLIDE ASSEMBLY FOR DETAILED  
 REPLACEMENT INSTRUCTIONS

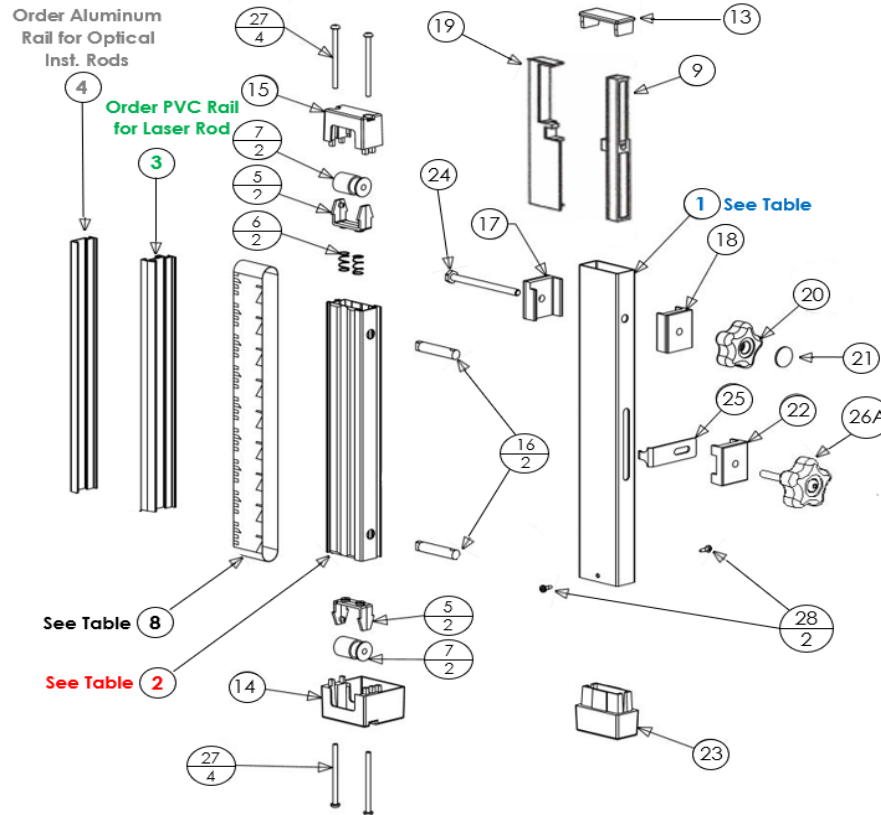

## DEMONSTRATION VIDEOS:

Scan QR code below or click on text, hyperlink included.

[TAPE REPLACEMENT](#)



[ALUMINUM OR PVC RAIL REPLACEMENT](#)

[SLIDE ASSEMBLY REPLACEMENT](#)



Housing Configurations (Items # 1 & 2)				
Rod	Rear Housing	Retail	Front Housing	Retail
10 FT	<a href="#">1000-1020-10</a>	\$59.90	<del>1000-1021-10</del>	\$53.25
15 FT	<a href="#">1000-1020-15</a>	\$86.50	<del>1000-1021-15</del>	\$79.85
3 M	<a href="#">1000-1020-3</a>	\$65.90	<del>1000-1021-3</del>	\$58.55
5M	<a href="#">1000-1020-5</a>	\$95.15	<del>1000-1021-5</del>	\$87.85
Rail Configurations (Items # 3 & 4)				
Rod	Laser PVC Rail	Retail	Survey Alum Rail	Retail
10 FT	<a href="#">1000-1022-10</a>	\$46.60	<del>1000-1032-10</del>	\$29.30
15 FT	<a href="#">1000-1022-15</a>	\$69.20	<del>1000-1032-15</del>	\$43.90
3 M	<a href="#">1000-1022-3</a>	\$46.60	<del>1000-1032-3</del>	\$29.30
5M	<a href="#">1000-1022-5</a>	\$69.20	<del>1000-1032-5</del>	\$43.90
Tape Configurations (Item # 8)				
Item	Part Number	Description	Retail	
10 FT	1000-1023	10ths /Cut & Fill	\$79.00	
10 FT	1000-1026	10ths Full Face	\$79.00	
10 FT	1000-1036	Inches /Cut & Fill	\$79.00	
10 FT	1000-1037	Inches / 10ths	\$79.00	
10 FT	1000-1038	Inches Full Face	\$79.00	
15 FT	1000-1501	10ths /Cut & Fill	\$110.00	
15 FT	1000-1504	10ths Full Face	\$110.00	
3 M	1000-1024	Metric Full Face	\$79.00	
3 M	1000-1035	Metric /Cut & Fill	\$79.00	
5 M	1000-1502	Metric Full Face	\$110.00	
5 M	1000-1503	Metric /Cut & Fill	\$110.00	

Item	Part Number	Description	Qty	Retail
5	1000-1011	SUPPORT, ROLLER	2	\$7.25
6	0000-1217	Spring, OD .360/ ID .310/ wire .026	2	\$0.35
7	1000-1018	ROLLER, TAPE	2	\$4.00
9*	<del>1000-1014</del>	<b>DISCONTINUED: USE 1000-1006-2 AS REPLACEMENT</b>		
13	1000-1002	CAP, REAR ROD TOP	1	\$3.20
14	1000-1001	CAP, FRONT ROD BOTTOM	1	\$11.75
15	1000-1000	CAP, FRONT ROD TOP	1	\$10.30
16	1000-1019	DOWELL, TOP & BOTTOM CAPS	2	\$10.90
17	1000-1005	CLAMP, ROD LOCK (LEFT)	1	\$5.85
18	1000-1004	CLAMP, ROD LOCK (RIGHT)	1	\$5.85
19*	<del>1000-1008</del>	<b>DISCONTINUED: USE 1000-1006-2 AS REPLACEMENT</b>		
20	1000-1015	KNOB, LOCK ROD LARGE	1	\$8.75
21	<b>Supplied w/Knob</b>	Cover, Rod Lock Knob Only Upon Request	1	\$0.00
22	1000-1012	GUIDE, TAPE LOCK PIN	1	\$7.25
23	1000-1003	FOOT, REAR ROD	1	\$5.85
24	0000-1600	BOLT, 1/4-20 X 3 1/4 HXHD Z	1	\$1.25
25	1000-1013	PIN, TAPE LOCK	1	\$9.00
26-A	0000-1604-K	LARGE LOCK KNOB W/SCREW, 1/4-20 X 2 BH SS	1	\$9.40
27	0000-1089	SCREW, 8-32 X 2.5 PHPAN	4	\$0.25
28	0000-1180	SCREW, # 6-3/8 PHPN MS SS	2	\$0.35
29	1000-1006-2	SLIDE REP KIT - SLIDE, KNOB, SCREW, LBL	1	\$23.80



# Retail Grade Rod Parts Breakdown

REV: B

DOM ON/AFTER: 07.30.24

REV B identifier is located on back of rod with LaserLine logo if not marked then assume REV A

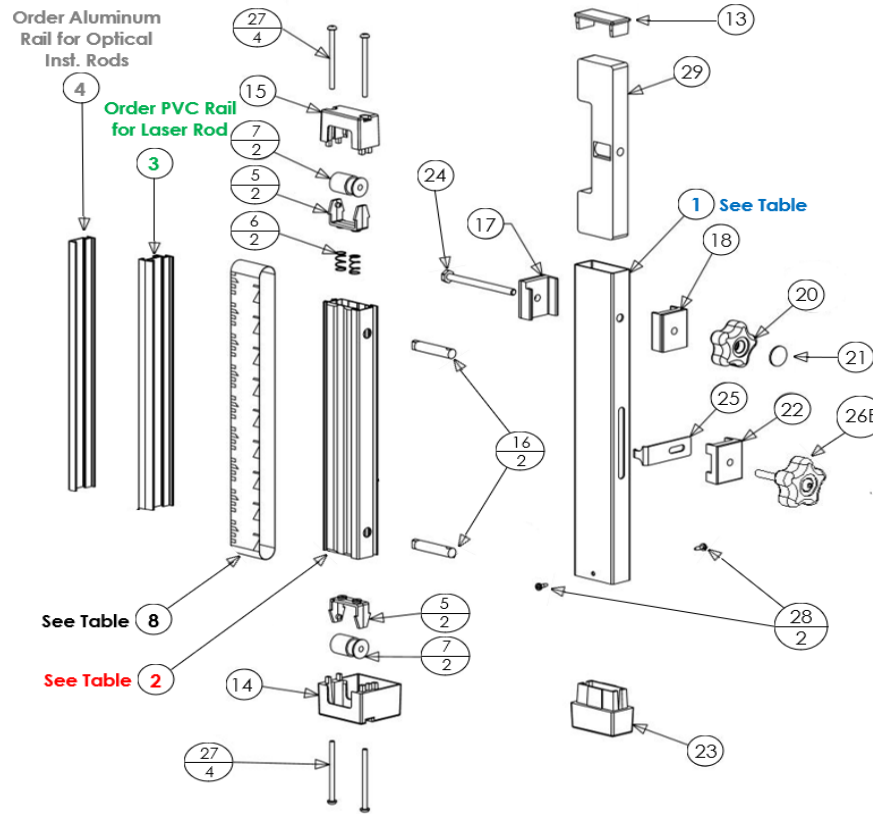

**DEMONSTRATION VIDEOS:**  
Scan QR code below or click on text, hyperlink included.

[TAPE REPLACEMENT](#) 

[ALUMINUM OR PVC RAIL REPLACEMENT](#) 

[SLIDE ASSEMBLY REPLACEMENT](#) 

Housing Configurations (Items # 1 & 2)				
Rod	Rear Housing	Retail	Front Housing	Retail
10 FT	<a href="#">1000-1020-10</a>	\$59.90	<a href="#">1000-1021-10</a>	\$53.25
15 FT	<a href="#">1000-1020-15</a>	\$86.50	<a href="#">1000-1021-15</a>	\$79.85
3 M	<a href="#">1000-1020-3</a>	\$65.90	<a href="#">1000-1021-3</a>	\$58.55
5M	<a href="#">1000-1020-5</a>	\$95.15	<a href="#">1000-1021-5</a>	\$87.85
Rail Configurations (Items # 3 & 4)				
Rod	Laser PVC Rail	Retail	Survey Alum Rail	Retail
10 FT	<a href="#">1000-1022-10</a>	\$46.60	<a href="#">1000-1032-10</a>	\$29.30
15 FT	<a href="#">1000-1022-15</a>	\$69.20	<a href="#">1000-1032-15</a>	\$43.90
3 M	<a href="#">1000-1022-3</a>	\$46.60	<a href="#">1000-1032-3</a>	\$29.30
5M	<a href="#">1000-1022-5</a>	\$69.20	<a href="#">1000-1032-5</a>	\$43.90
Tape Configurations (Item # 8)				
Item	Part Number	Description	Retail	
10 FT	1000-1023	10ths /Cut & Fill	\$79.00	
10 FT	1000-1026	10ths Full Face	\$79.00	
10 FT	1000-1036	Inches /Cut & Fill	\$79.00	
10 FT	1000-1037	Inches / 10ths	\$79.00	
10 FT	1000-1038	Inches Full Face	\$79.00	
15 FT	1000-1501	10ths /Cut & Fill	\$110.00	
15 FT	1000-1504	10ths Full Face	\$110.00	
3 M	1000-1024	Metric Full Face	\$79.00	
3 M	1000-1035	Metric /Cut & Fill	\$79.00	
5 M	1000-1502	Metric Full Face	\$110.00	
5 M	1000-1503	Metric /Cut & Fill	\$110.00	

Item	Part Number	Description	Qty	Retail
5	1000-1011	SUPPORT, ROLLER	2	\$7.25
6	0000-1217	Spring, OD .360/ ID .310/ wire .026	2	\$0.35
7	1000-1018	ROLLER, TAPE	2	\$4.00
13	1000-1002	CAP, REAR ROD TOP	1	\$3.20
14	1000-1001	CAP, FRONT ROD BOTTOM	1	\$11.75
15	1000-1000	CAP, FRONT ROD TOP	1	\$10.30
16	1000-1019	DOWELL, TOP & BOTTOM CAPS	2	\$10.90
17	1000-1005	CLAMP, ROD LOCK (LEFT)	1	\$5.85
18	1000-1004	CLAMP, ROD LOCK (RIGHT)	1	\$5.85
20	1000-1015	KNOB, LOCK ROD LARGE	1	\$8.75
21	Supplied w/Knob	Cover, Rod Lock Knob Only Upon Request	1	\$0.00
22	1000-1012	GUIDE, TAPE LOCK PIN	1	\$7.25
23	1000-1003	FOOT, REAR ROD	1	\$5.85
24	0000-1600	BOLT, 1/4-20 X 3 1/4 HXHD Z	1	\$1.25
25	1000-1013	PIN, TAPE LOCK	1	\$9.00
26-B	0000-1132-K	LARGE LOCK KNOB W/SCREW, 1/4-20 X 2 1/4 BHSC SS	1	\$9.40
27	0000-1089	SCREW, 8-32 X 2.5 PHPAN	4	\$0.25
28	0000-1180	SCREW, # 6-3/8 PHPN MS SS	2	\$0.35
29	1000-1006-2	SLIDE REP KIT - SLIDE, KNOB, SCREW, LBL	1	\$23.80